

Features:

- M8*1 mm , Brass,nickel-plated housing;
- 2mm , non-flush mountable;
- DC 3-wire , switching output;
- Connector versions



RoHS **CE**

Dimensioned drawing

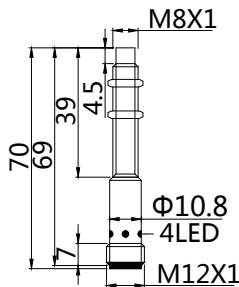

Mounting

(non-flush mounting)

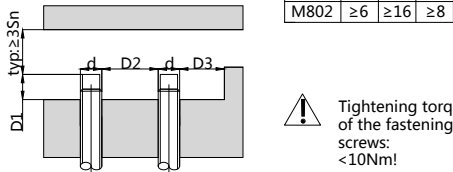

Correction Factor	
Nav-ferrous metal	Factor
Water	1
Alcohol	0.7
Ceramic	0.6
Glass	0.5
Oil	0.3

Model No.

Sensing range	Sn:2 mm
NPN N. O	SCN-M8-02N-C11-M12
NPN N. C	SCN-M8-02N-C21-M12
PNP N. O	SCN-M8-02P-C11-M12
PNP N. C	SCN-M8-02P-C21-M12

Technical data

Electrical data	Operating voltage	10-30V DC
	Switching frequency	100Hz
	Voltage drop	≤2.0V
	Leakge current	<0.01mA
	Load current	100mA
	No load current	≤10mA(24V)
	Hysteresis	<15%(Sr)
	Repeatability	<5.0%(Sr)
	Temperature drift	<10%(Sr)
	Short circuit protection	Yes
	Overload protection	Yes
	Polarity reversal protection	Yes
Environment	Ambient temperature	-25...70°C
	Ingress protection	IP67
Mechanical data	Housing material	Brass,nickel-plated
	Face material	POM
Electrical connection	Connectors	M12 connector

Wiring

