



**Features:**

- M30\*1.5 mm , Plastic/Brass,nickel-plated housing;
- 30mm , non-flush mountable;
- DC 3-wire , switching output;
- Connector versions



**Dimensioned drawing**

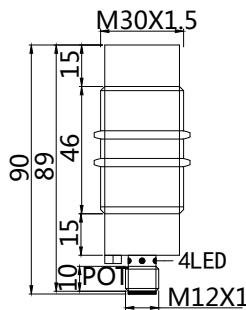

**Mounting**

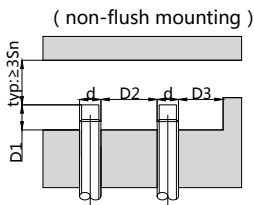

Sn	D1	D2	D3
M3030	≥40	≥60	≥30

⚠ Tightening torque of the fastening screws: <40Nm!

⚠ Tightening torque of the fastening screws: <1.5Nm!(PBT)

Correction Factor	
Nav-ferrous metal	Factor
Water	1
Alcohol	0.7
Ceramic	0.6
Glass	0.5
Oil	0.3

**Model No.**

Housing material	Brass, nickel-plated	PBT
NPN N. O	SCN-M30-30N-C11-M12	SCN-M30-30N-P11-M12
NPN N. C	SCN-M30-30N-C21-M12	SCN-M30-30N-P21-M12
PNP N. O	SCN-M30-30P-C11-M12	SCN-M30-30P-P11-M12
PNP N. C	SCN-M30-30P-C21-M12	SCN-M30-30P-P21-M12

**Technical data**

<b>Electrical data</b>	Operating voltage	10-30V DC
	Switching frequency	100Hz
	Voltage drop	≤2.0V
	Leakge current	<0.01mA
	Load current	200mA
	No load current	≤10mA(24V)
	Hysteresis	<15%(Sr)
	Repeatability	<5.0%(Sr)
	Temperature drift	<10%(Sr)
	Short circuit protection	Yes
Overload protection	Yes	
Polarity reversal protection	Yes	
<b>Environment</b>	Ambient temperature	-25...70°C
	Ingress protection	IP67
<b>Mechanical data</b>	Housing material	Brass,nickel-plated/PBT
	Face material	PBT
<b>Electrical connection</b>	Connectors	M12 connector

**Wiring**

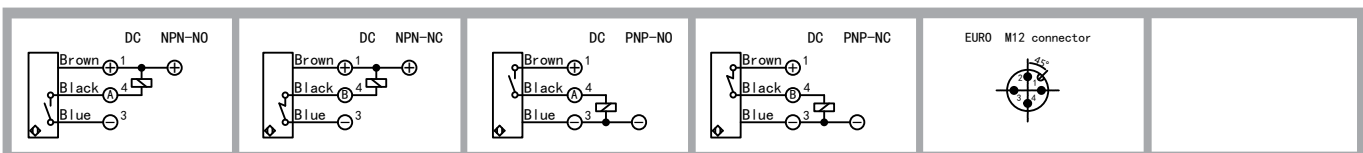

General Information

Inductive Sensors

Capacitive Sensors

Photoelectric Sensors

Ultrasonic Sensors

Solid state relay series

Connectors

Accessories

Index Of Types